

**PARTS LIST**

Part Number	Description
DC15105	Weighted Filter Bag
DC15102	Motor Cover
DC15104	Motor Brackets (2 Required)
DC15400	Motor
2055	Cartridge Filter
DC15110	Filter Bracket
DC15106	6' Dust Collector Hose

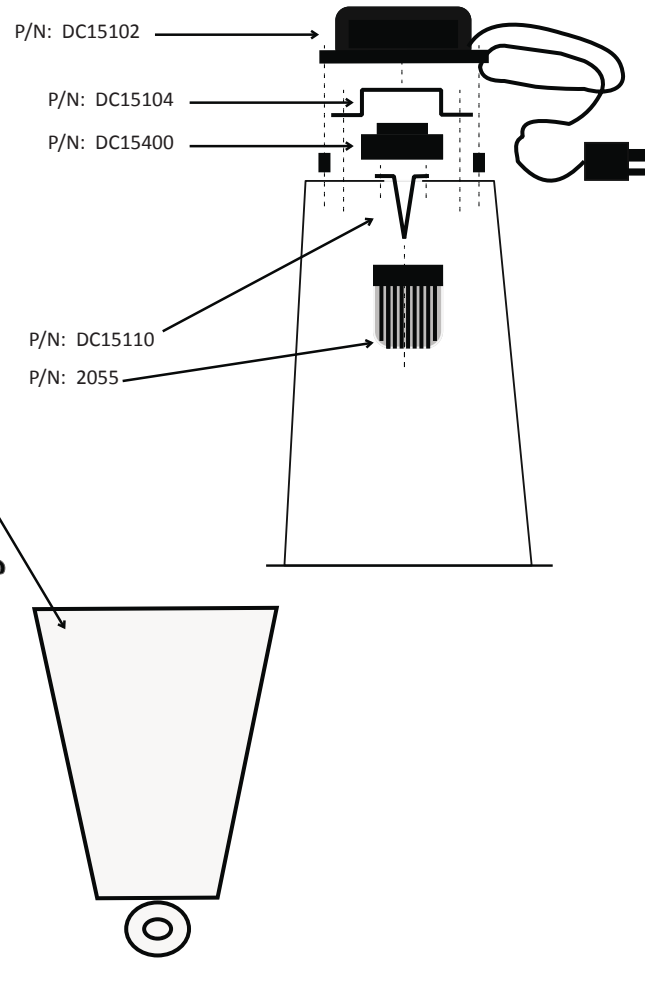

**WARRANTY**

Due to the nature of the environment that this unit will operate in and knowing that its effective performance depends on the owner's cooperation in following the maintenance and safety tips, the motor and filter bag are warranted for 90 days from the date of purchase, by the original owner. User should call the factory in the event of defective parts. If found defective, the parts will be repaired or replaced at the manufacturer's discretion. This warranty grants the user certain legal rights. Users and purchasers may also be protected by other rights which vary from state to state.

**NOTE: EXCEPT FOR WARRANTIES SET FORTH ABOVE, THE MANUFACTURER MAKES NO OTHER WARRANTIES OF ANY KIND, EXPRESS OR IMPLIED, INCLUDING WARRANTIES OF MERCHANTABILITY OR FITNESS OF A PRODUCT FOR A PARTICULAR PURPOSE.**



PO Box 815  
Dowagiac, MI 49047  
269-782-9670 (phone)  
269-782-9623 (fax)

Operation Manual & Parts List for the  
DC-1500 Dust Collection System

info@cycloneblasters.com \* cycloneblasters.com

**ATTENTION**

***Please read instructions before operating this system.***

The DC-1500 dust collection system is a powerful vacuum system designed to improve visibility within an abrasive blast cabinet. Producing approximately 90 CFM (Cubic Feet per Minute), this is an ideal means of making the abrasive blast process better for the user.

**Safety alert signal words based on ANSI Z535.4-1998 are used to alert the user of a potentially hazardous situation that may be encountered during operation of this equipment. ANSI definitions are as follows.**

- CAUTION** { Caution used without the alert symbol indicates a potentially hazardous situation which, if not avoided, may result in property damage.
- ! CAUTION** { Caution indicates a potentially hazardous situation which, if not avoided, may result in minor or moderate damage.
- ! WARNING** { Warning indicates a potentially hazardous situation which, if not avoided, could result in serious injury or death.
- ! DANGER** { Danger indicates an imminently hazardous situation which, if not avoided, will result in serious injury or death.

**! DANGER**

1. Follow all electrical and safety codes as well as the National Electric Code (NEC) and the Occupational Safety & Health Act (OSHA).
2. Follow assembly instructions BEFORE plugging system into electrical outlet. Always unplug unit before servicing/performing maintenance to avoid personal injury or damage to the unit.

**SAFETY TIPS: Before you begin using your new unit, we want to help protect you and your product from injury or damage.**

**! WARNING** FIRST: This unit is designed to pick up dry material ONLY. It is not meant to be used in ANY situation where moisture or water is present. THIS IS NOT A WET VACUUM SYSTEM. SERIOUS INJURY OR EQUIPMENT DAMAGE WILL OCCUR IF THIS WARNING IS DISREGARDED.

**CAUTION** SECOND: The DC-1500 is designed to be used for 2 to 5 hours per day.

**! WARNING** THIRD: This unit is equipped with a grounded three prong electrical plug. If your outlet does not accept this plug, please have a qualified electrician replace the outlet.

**! DANGER** FOURTH: This unit has a motor with an OPEN BRUSH HOLDER design. A spark can be expected when the motor starts up. This unit must not be used in an environment where airborne substances could be volatile and cause an explosion.

## MAINTENANCE

The DC1500 dust collection system requires regular owner maintenance. The unit must have debris emptied from the lower housing's canister filter and weighted filter bag. The weighted filter bag should be shaken out every other day. The cartridge filter should be gently blown off with air at the same time. If the cartridge is removed for cleaning or replacement, please ensure to place a bead of silicone sealant around the black seal ring of the cartridge filter before reinstalling. Adequately tighten the nut holding the filter onto the bracket.

### **WARNING**

When performing maintenance on this unit always unplug it from any electrical source. When removing any components for maintenance, ensure to follow instructions and take any and all reasonable safety precautions while performing maintenance.

## TROUBLESHOOTING

**NOTE:** Each time the DC-1500 is started, dust may blow out from the top of the unit. This is normal for the first several minutes of operation. If dust continues to blow out of the top near the motor as it is being used, consult the troubleshooting guide or contact the factory.

Problem	Cause	Remedy
No filter bag installed	Install filter bag	Replace filter bag
Hole developed in filter bag	Replace filter bag	Replace filter bag
Unit incorrectly assembled	Check alignment of top and bottom housings, ensure good fit, ensure spring is properly set in lip of lower housing.	Replace abrasive / switch to more course abrasive
Possibility of worn abrasive or abrasive is too fine.	Replace brushes or motor	Replace brushes or motor
Motor has failed	Replace motor. Also replace filter bag to ensure old contaminants are not introduced into a new motor.	Replace motor. Also replace filter bag to ensure old contaminants are not introduced into a new motor.

**DANGER** DO NOT USE THIS UNIT AS A WET VACUUM  
**DANGER** Any water or moisture that gets into the unit may cause serious injury or death to the operator and or damage to the vacuum motor

## ASSEMBLY

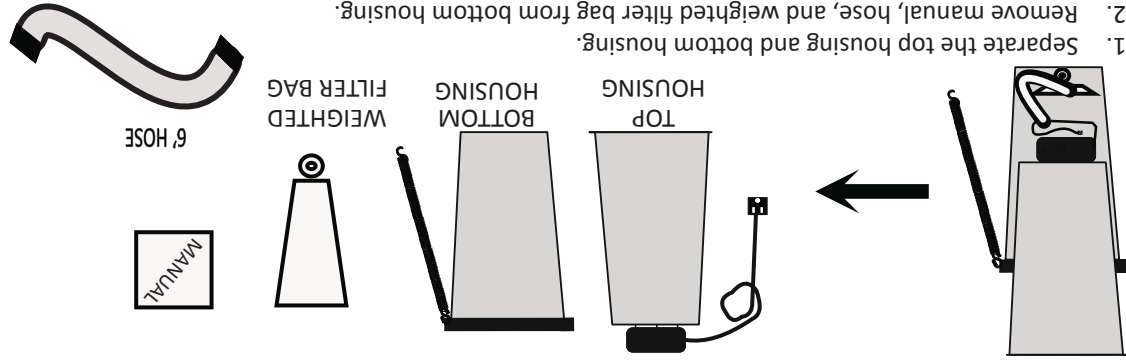

1. Separate the top housing and bottom housing.
2. Remove manual, hose, and weighted filter bag from bottom housing.
3. Place the upper housing on the floor with the open end up.
4. Make sure the nut holding the cartridge filter in place is tight.
5. Place the weighted filter bag into the upper canister. The weight should be visible when the bag is properly in place. Drape the edge of the bag over the rim.
6. Set the top housing into position over the bottom housing. This will pinch the filter bag all around the perimeter between the rims of housings.
7. After placing housings together, pull the spring up over the lip to clamp the unit together. Note that the spring has two S-Clips, one comes attached. Find the hole in the lower housing and attach the other end of the spring's S-Clip.
8. Insert your 2.25" diameter hose into the lower housing.
9. Plug the unit into a properly grounded electrical outlet.

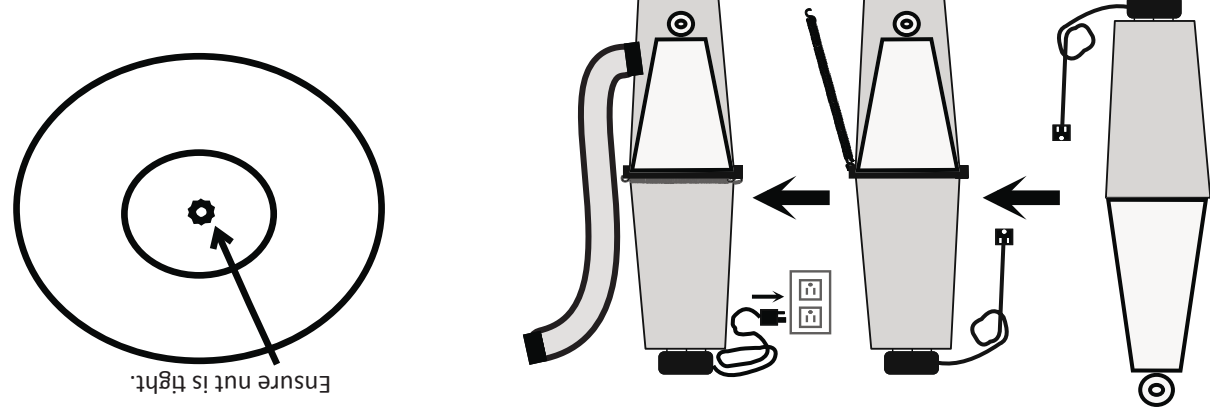

Overhead view of Top Housing.

Ensure nut is tight.

1. Place filter bag over the lip of the bottom housing. Make certain that the weight hangs down and outside of the bag. This assures that the smooth side of the bag exposed to debris and that the fuzzy side of the filter goes toward the motor.
2. The top housing should slide under the spring and settle into the lower housing.
3. The spring holds the top and bottom housing together and lays inside the lower housing's lip.

**DANGER** DO NOT USE THIS UNIT AS A WET VACUUM  
**DANGER** Any water or moisture that gets into the unit may cause serious injury or death to the operator and or damage to the vacuum motor